

**Légende :**

	RESEAUX SOLAIRE THERMIQUE DEPART ET RETOUR
	RESEAU DESCENDANT/MONTANT DE NIVEAU
	PANNEAU SOLAIRE THERMIQUE
	CUVE DE STOCKAGE
	KIT HYDRAULIQUE

**ACTIO PLÂTRE**  
 B.P. 2056 - 98810 MONT-DORE  
 Tél / Fax: 24.06.50  
 Ridet: 394130.001

*Belin*  
 B.P.

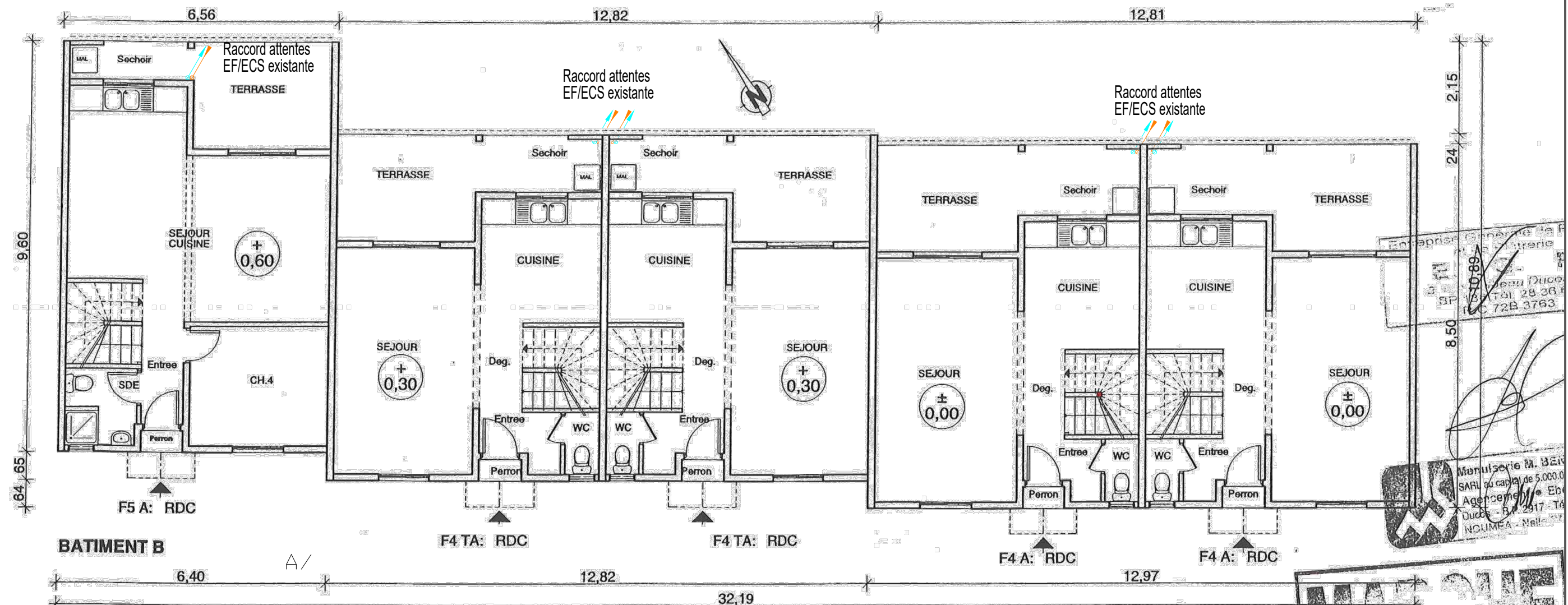

Entrepreneur Générale la P...  
 B.P. 170-89  
 Jean Duce...  
 Tél: 28 26...  
 F.C. 72B 3763

Menuiserie M. BÉ...  
 SARL au capital de 5.000.0...  
 Agence...  
 Duce... B.P. 2917 - TA...  
 NOUMEA - Noll...

**MAISON**

SARL  
**DR COSTANTIN**  
 CHARPENTES MÉTALLIQUES & BOIS  
 FRANCHISE SOLAIRE

FSH SECAL

MODIFICATIONS	DATE	INDICE
Creation	04/20	0
Modification	05/20	1







**CES PALMIERS 1 & 2**

PLAN D'IMPLANTATION ECS - Bat B - RDC

DOSSIER **DCE**

PIECE **ECS-B1** 1/100

**Légende :**

	RESEAU SOLAIRE THERMIQUE DEPART ET RETOUR
	RESEAU DESCENDANT/MONTANT DE NIVEAU
	PANNEAU SOLAIRE THERMIQUE
	CUVE DE STOCKAGE
	KIT HYDRAULIQUE

**ACTION PLÂTRE**  
 B.P. 2056 - 98810 MONT-DORE  
 Tél / Fax: 24.06.50  
 Rider: 394130.001

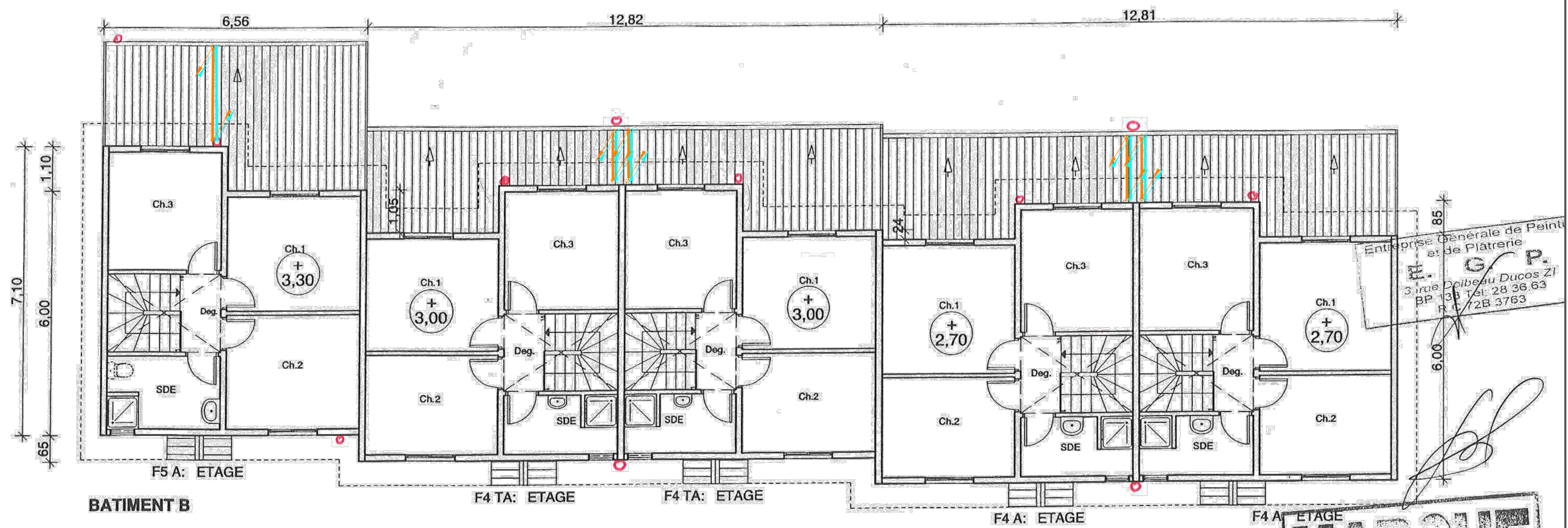
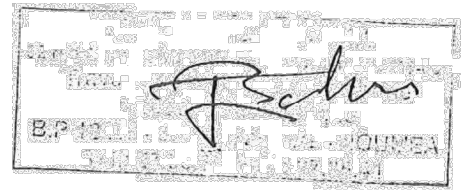

Entreprise Générale de Peinture  
 et de Plâtrerie  
**G.P.**  
 3 rue Doibeau Ducos ZI  
 BP 138 Tél: 28 36 63  
 R.P. 12B 3763

MEGE SOCIAL : B. VAUBAN  
 TEL: 27 32 66 - B.P. 302  
 NOUMEA Nouvelle Calédonie

**J.P. COSTANTINI**  
 CHARPENTES MÉTALLIQUES & BOIS  
 COUVERTURE ÉTANCHÉITE ISOLATION  
 B.P. 2338 - 98846 - NOUMEA  
 Tél: 27 22 23

**FSH**  
**LES PALMIERS 1&2**

MODIFICATIONS	DATE	INDICE
Creation	04/20	0
Modification	05/20	1







**CES PALMIERS 1 & 2**

PLAN D'IMPLANTATION ECS - Bat B- R+1

DOSSIER **DCE**

PIECE **ECS-B2** 1/100

**Légende :**

	RESEAUX SOLAIRE THERMIQUE DEPART ET RETOUR
	RESEAU DESCENDANT/MONTANT DE NIVEAU
	PANNEAU SOLAIRE THERMIQUE
	CUVE DE STOCKAGE
	KIT HYDRAULIQUE

**ACTION PLÂTRE**  
 B.P. 2056 - 98310 MONT-DORE  
 Tél / Fax: 24.06.50  
 Ridet: 394130.001

*Signature*  
 B.P. 1

Entreprise Générale de Peinture  
 et de Plâtrerie  
 S.P.  
 138 F. 36.63  
 R.C. 148763

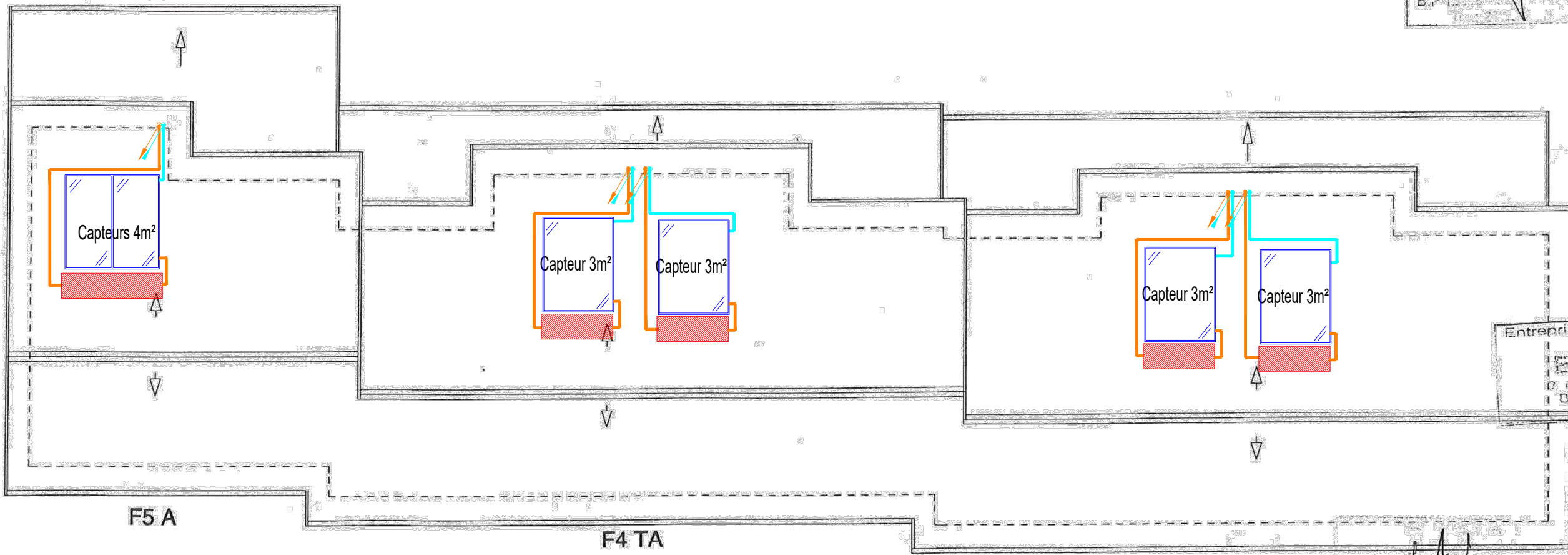

**BATIMENT B TOITURE**

*Arbe*  
 REGIE SOCIAL : 2Bd VAUBAN  
 EL : 27.32.66 - B.P. 002  
 NOUMEA - Nouvelle Calédonie

Menuiserie M. BENE  
 SARL au capital de 5.000.000 Fr  
 Agencement de Fenêtres  
 Ducos - B.P. 2917 - Tél. 27.33.88  
 NOUMEA - Nouvelle Calédonie

**ALBEDO**

FSH

SECAL

MODIFICATIONS	DATE	INDICE
Creation	04/20	0
Modification	05/20	1



**CES PALMIERS 1 & 2**

PLAN D'IMPLANTATION ECS - Bat B- Toiture

DOSSIER **DCE**

PIECE **ECS-B3**

1/100