





**Légende :**

	RESEAUX SOLAIRE THERMIQUE DEPART ET RETOUR
	RESEAU DESCENDANT/MONTANT DE NIVEAU
	PANNEAU SOLAIRE THERMIQUE
	CUVE DE STOCKAGE
	KIT HYDRAULIQUE

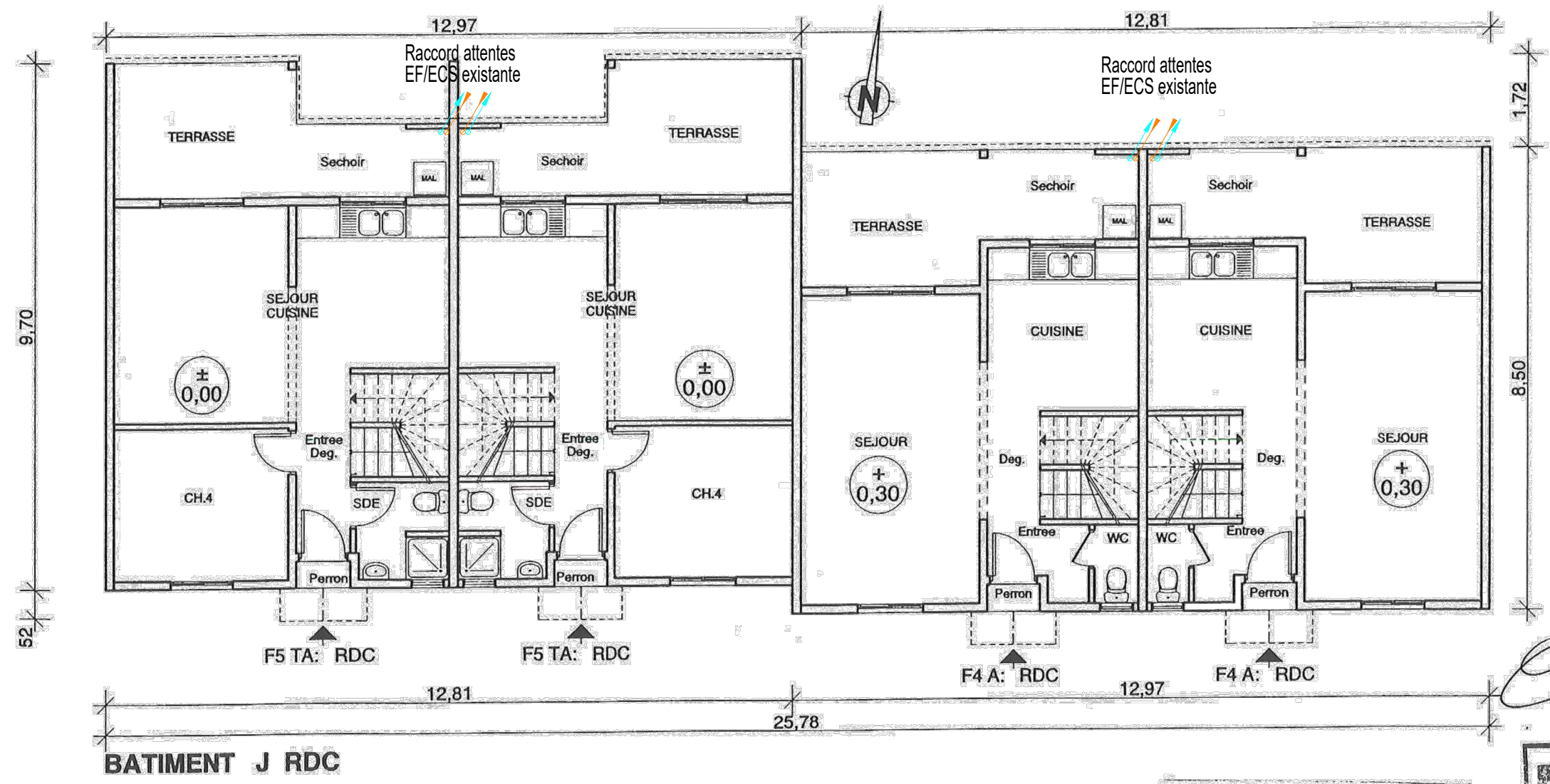

**ACTION PLANS**  
 B.P. 2056 - 98810 MONT  
 Tel / Fax: 24.06  
 Ridet: 394130.00

Entreprise Générale de Peintures  
 et de Plâtrerie  
 3, rue Dailly - Noumea  
 BP 138 - 98800  
 R.C. 123 0753

SARL  
**J.P. COSTANTINI**  
 CHARPENTES MÉTALLIQUES & BOIS  
 COUVERTURE - ÉTANCHÉITÉ - ISOLATION  
 B.P. 2338 - 98846 NOUMEA  
 ☎ 27 55 79 - FAX 27 33 23  
 RC 968 450387 - RIDET 450387 001

*Signature*  
 B.P. 138 - 98800

**ALBEDO**  
 Pour une énergie mieux réfléchie

*Signature*  
 FSH  
 SECA

MODIFICATIONS	DATE	INDICE
Creation	04/20	0







**CES PALMIERS 1 & 2**

PLAN D'IMPLANTATION ECS - Bat J- RDC

DOSSIER **DCE**

PIECE **ECS-J1** 1/100

**Légende :**

	RESEAUX SOLAIRE THERMIQUE DEPART ET RETOUR
	RESEAU DESCENDANT/MONTANT DE NIVEAU
	PANNEAU SOLAIRE THERMIQUE
	CUVE DE STOCKAGE
	KIT HYDRAULIQUE

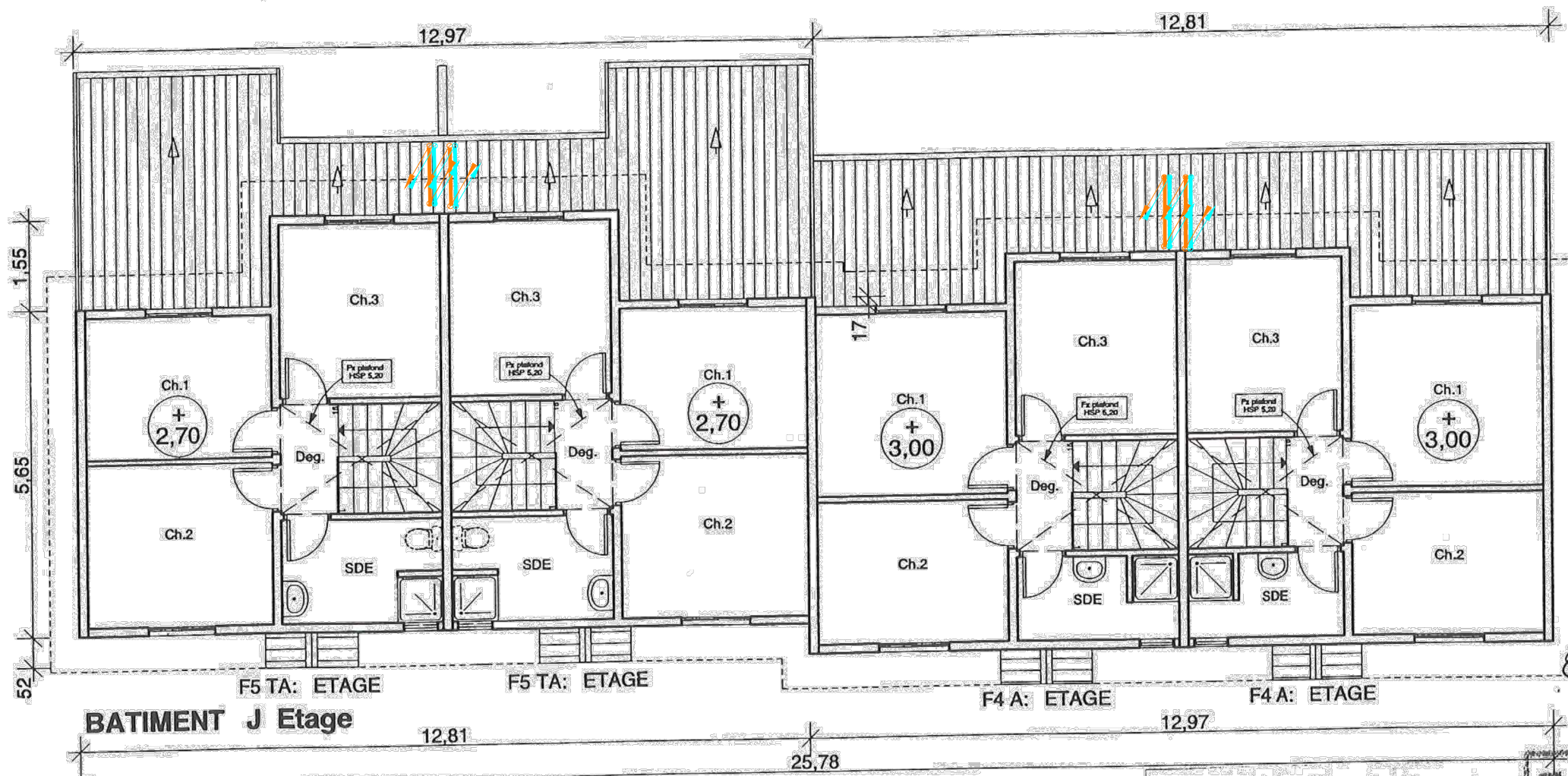

**ACTION PLÂTRE**  
 B.P. 2056 - 98810 MONT-DORE  
 Tél / Fax: 24.06.50  
 Ridet: 394130.001

Entreprise Générale de Peinture  
 et de Plâtrerie  
**E. A. S.**  
 3 rue Domini Ducos, ZI  
 BP 130 - Tél: 28 36 63  
 P.C. 72B 3763

SARL  
**DR COSTEYRIN**  
 CHARPENTES MÉTALLIQUES & BOIS  
 COUVERTURE ÉTANCHÉRIE ISOLATION  
 B.P. 2338 - 98846 - NOUMEA  
 ☎ 27 55 79 - FAX 27 33 23  
 RC 908 450 387 - Réc: 450387 001

*Bebe*

**ARBE**

**Arbe**  
 SIEGE SOCIAL 2Rd LAUBAN

*Signature*

**FSH** **SECAL**  
**LES PALMIERS 1&2**

Menuiserie M. BENEYTOU  
 SARL au capital de 5.000.000 Frs-CFP  
 Agencement et Installation

Logements en bande PALMIERS 2  
 BATIMENT J DCE

MODIFICATIONS	DATE	INDICE
Creation	04/20	0







**CES PALMIERS 1 & 2**

PLAN D'IMPLANTATION ECS - Bat J- R+1

DOSSIER **DCE**

PIECE **ECS-J2** 1/100

**Légende :**

	RESEAUX SOLAIRE THERMIQUE DEPART ET RETOUR
	RESEAU DESCENDANT/MONTANT DE NIVEAU
	PANNEAU SOLAIRE THERMIQUE
	CUVE DE STOCKAGE
	KIT HYDRAULIQUE

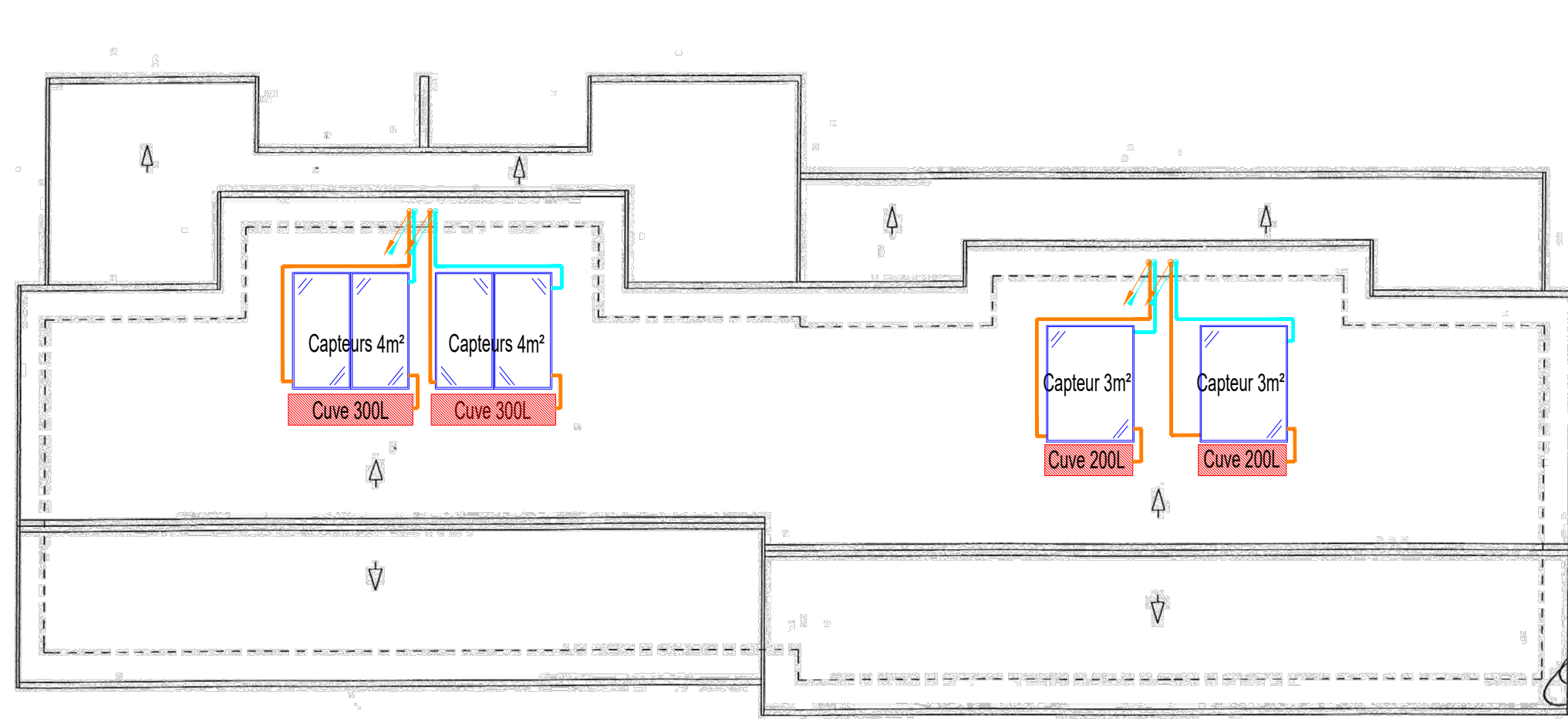

**BATIMENT J toiture**

**ACTION PLÂTRE**  
 B.P. 2056 - 98810 MONT-DORE  
 Tél / Fax: 24.06.50  
 Ride: 394130.001

Entreprise Générale de Peinture  
 et de Plâtrerie  
 E. DOLL  
 BP 140 - 98828 ZI  
 RC 228 3763

**J.P. COSTEYRON**  
 CHARPENTES MÉTALLIQUES & BOIS  
 COUVERTURE ÉTANCHÉITÉ ISOLATION  
 B.P. 2338 - 98846 NOUMEA  
 ☎ 27 55 79 FAX 27 33 23  
 RC 468 450787 RC 450387 001

*Batur*  
 NOUMEA

**SECAL**  
 LES PALMIERS 1&2  
 Logements en bande PALMIERS 2

FSH  
 SECAL  
 LES PALMIERS 1&2  
 Logements en bande PALMIERS 2

MODIFICATIONS	DATE	INDICE
Creation	04/20	0



**CES PALMIERS 1 & 2**

PLAN D'IMPLANTATION ECS - Bat J- Toiture

DOSSIER **DCE**

PIECE **ECS-J3** 1/100